

# Analysis of the causes of solar inverter white screen



## Overview

---

The most likely causes are a failed display module, a faulty low-voltage power supply, or a main control board failure. If under warranty, arrange for professional service or replacement. The mysterious "white screen syndrome" has left many solar system owners scratching their heads. Let's dissect this modern solar puzzle like detectives at a crime scene. Ever walked up to your photovoltaic inverter expecting to see performance data, only to find a ghostly white screen staring back?

. If an inverter's display panel is blank while input power is confirmed present, follow these steps for diagnosis and resolution: Use a multimeter to confirm correct voltage at the inverter's AC input terminals. Check for correct polarity and phase (if applicable). Measure DC voltage from the. When the inverter 's display goes blank, it often indicates a disruption in the DC input or an internal fault. If the DC isolator is open, the inverter cannot receive power, leading to a blank display.

## Analysis of the causes of solar inverter white screen

---



 LFP 12V 100Ah

### Common Solar Inverter Problems and How to Fix Them

Solar inverter problems can cause performance dips, system outages, and even long-term damage to your setup if left unaddressed. In this article, we'll break down the most common ...

### Tesla Solar Inverter Solid White Light - Troubleshooting

Learn if a solid white light on your Tesla solar inverter is normal and what it indicates. A solid white light on a Tesla solar inverter typically signifies that the inverter is powered on but not actively ...



### Orion Solar Inverter Blank Display

Learn how to troubleshoot a blank display issue on your Orion Solar Inverter effectively. When the inverter's display goes blank, it often indicates a disruption in the DC input or an internal fault. The ...

## 4. Troubleshooting and Support

For unexpected behaviour or suspected product faults, refer to this chapter. Start by checking the common issues described here. If the problem persists, contact the point of purchase (Victron dealer ...

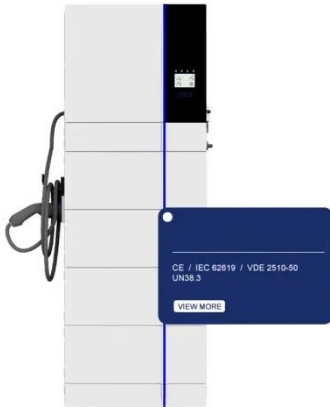

### SolarEdge Isolation Fault Troubleshooting

If you cannot see the inverter panel, or if a malfunction is indicated on the LCD panel, wait at least five minutes for the input capacitors of the inverter to discharge.

### Solar Inverter Problems & Solutions , How Do I Fix?

Problem 1: No Display on the Inverter.  
 Issue: The inverter screen is blank or doesn't show any readings. Solution:  
 Step 1: Ensure the inverter is turned on.  
 Step 2: Check if there's a tripped ...



### Troubleshooting Steps for Blank Inverter Display with Input Power

Learn how to diagnose and resolve a blank inverter display despite confirmed input power, including checking input power, DC bus voltage, fuses, display

panel power supply, error ...

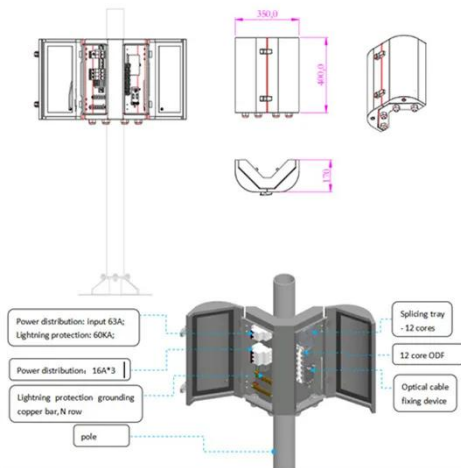

## Common Solar Inverter Issues and How to Fix Them

Solar inverters are the workhorses of any solar power system. They take the raw DC electricity from your panels and turn it into the AC power your home or business actually uses. When ...



## Analysis of the causes of photovoltaic inverter white screen

Analysis of the causes of photovoltaic inverter white screen Due to the deep coupling of the DC faults for the two-stage photovoltaic (PV) inverters, it is very difficult to determine the specific causes of DC faults.

## Why Is Your Solar Inverter Screen Blank? 7 Shocking Causes Behind ...

The mysterious "white screen syndrome" has left many solar system owners scratching their heads. Let's dissect this

modern solar puzzle like detectives at a crime scene.



## Contact Us

---

For catalog requests, pricing, or partnerships, please visit:  
<https://scelto.co.za>

